

R-65A-1/4" Air Regulator (Replaces R-65-1/4" Air Regulator)

R4LT-1-1/4" Regulator Assembly

WARNING: Maximum supply air pressure 110 p.s.i. Temperature range 40° to 120°F.

OPERATING INSTRUCTION & REPLACEMENT PARTS

INSTALLATION:

These units have tapered pipe threads; use pipe compound or tape sparingly on the male threads. Install regulator item #8 into tank cover. Attach air supply line to item #4 (HF-33).

PRESSURE ADJUSTMENT:

To unlock adjustment, pull the adjusting knob out. Turn the knob clockwise to increase regulated pressure and counter-clockwise to lower pressure. With relieving-type regulators, the reduced pressure follows adjustment of the screw. To lock adjustment, simply push the adjusting knob back in.

MAINTENANCE AND CLEANING:

If air supply is kept clean, the regulator should provide long uninterrupted service. Erratic regulator operation or loss of regulation is most often due to dirt in the disc area. To clean, shut off and depressurize the airline and disassemble the regulator. Clean parts with household soap and blow out body with compressed air. When reassembling, make sure the seat is firmly in place and that the disc stem fits into the center hole of the diaphragm assembly. Tighten the four screws of the bonnet to secure the complete assembly.

CAUTION:

To avoid damage to the gauge; before turning on air supply, turn the Adjusting Knob counter-clockwise to reduce pressure setting of regulator.

R4LT-1-1/4"

No.	Part No.	Description
1.	R-65A-1/4"	Air Regulator
2.	1/4" AHPP	Allen Pipe Plug
3.	HF-1/4"-90	Elbow
4.	HF-33	Coupler
5.	HF-1/4"	Valve Assembly
6.	HF-560L	4 Way Tee
7.	HRV-1/4"	Release Valve
8.	HF-34AS	Splash Coupler
9.	PU-725	1/4" Pop Valve
10.	GB-2"-60#	Gauge

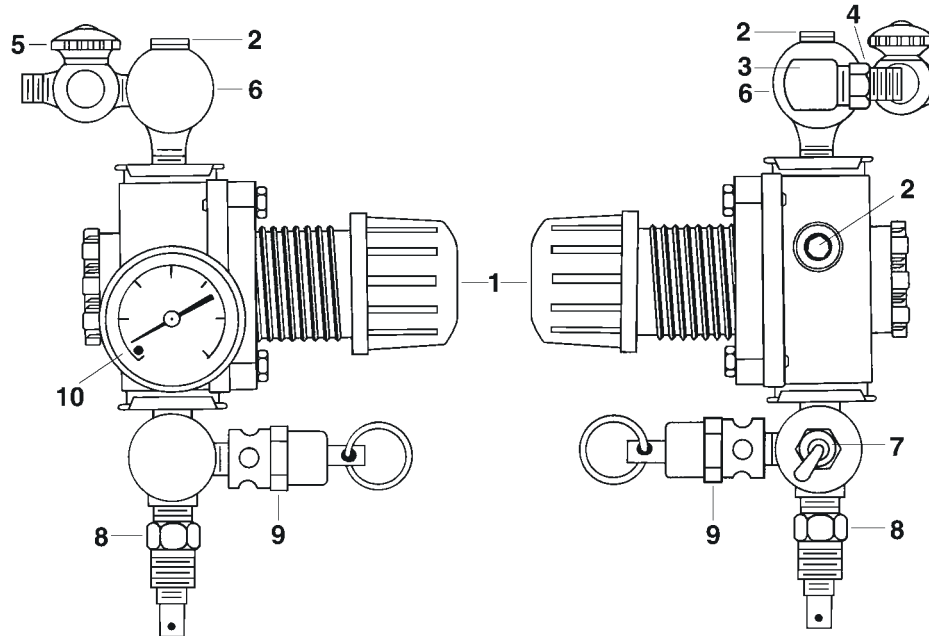

AIR REGULATOR Assembly Diagram

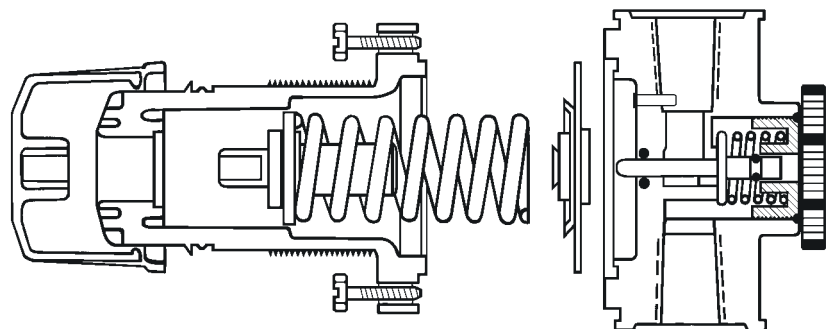

Paasche Airbrush Company

7440 West Lawrence Avenue
Harwood Heights, IL 60706-3412

Phone: 708/867-9191 • Fax: 708/867-9198

Websites: paascheairbrush.com and

paasche.thomasregister.com or E-Mail: paascheair@aol.com