



CU- MANUAL SPRAY GUN

OPERATING INSTRUCTIONS & REPLACEMENT PARTS

DESCRIPTION:

CU- Manual Spray Guns are for use from Low to Medium Pressure with Light to Heavy Fluids. They will cover a range of materials to include heavy Abrasives, Enamels, Latex, and Lacquers etc. See page 2 for different styles of Spray Head Components and page 4 for information on available Fluid Bodies. These Models require 3 to 24 C.F.M. at 30 to 50 lbs. Air Pressure depending on Spray Head selected and Material being sprayed.

CONNECTIONS:

Spray Guns have the following threaded connections: Air inlet 1/4" N.P.T. (Male) and Fluid inlet 3/8" N.P.T. (Male).

MATERIAL:

Mixture should be to the consistency recommended by the manufacturer. Strain through cloth or fine mesh wire prior to using material. This will insure that all foreign particles are removed.

OPERATION:

1. Blow out all airline hoses before connecting to the Spray Gun to remove foreign particles.
2. Connect HT-1/4 or 5/16 Air Hose to air inlet fitting.
3. Connect HA-1/4 or 3/8 Fluid Hose to fluid inlet.
4. Tighten all hose connections securely.
5. Adjust air pressure to required amount at the Regulator & Moisture Condenser Unit.
6. Adjust fluid volume on the CUF- Model by turning the 200-17 Fluid Knob.
7. The Fan pattern is controlled by turning the U-2065 Fan Control Screw on the CUF- Model.
8. Test spray on some cardboard or news paper for final adjustment before spraying your project.

MAINTENANCE:

The specially treated leather packings (U-28) should be replaced at least once a month. Old U-28 Packing Washers can cause leakage of air and fluid. Teflon® Packings (59-28 Packing Assembly) are self-lubricating.

CLEANING:

After each use flush clean solvent through the fluid passages of the Spray Gun and wipe off the outside with clean solvent. Never leave the entire Spray Gun immersed in solvent. Dirty Aircaps and Tips should be cleaned by soaking in solvent and then blown clean with air. **Personal Safety Equipment should be used at all times.**

WARNING: Spray materials may be harmful if inhaled or allowed to come into contact with the skin or eyes. Consult the product label and Material Safety Data Sheet supplied for the spray material. Follow all safety precautions.
CAUTION: Well Ventilated Area Required to remove fumes, dust or overspray. Secure airhose and fluid hose wrench tight for safety and to prevent leaks.
Maximum Air Pressure 100 P.S.I.
Maximum Fluid Pressure 45 P.S.I.

TROUBLE SHOOTING SPRAY PATTERNS:

- A. A ROUGH OR STIPPLE FINISH** is due to low or restricted flow of air pressure or heavy materials being applied with the spray gun too close to surface.
- B. A WET OR SAGGING FINISH** is due to low air pressure or restricted flow of air, material being too thin or applied too close to the surface.
- C. A SPATTERING SPRAY** is caused by air leaking into fluid line or can be caused by a loose fluid tip, a broken or split tip, lumpy material, a clogged vent hole in cover of material cup, air leak at fluid pipe attached to inside of tank cover, or a clogged paint strainer.
TO CORRECT: Tighten tip securely or replace. Strain material and clean strainer. Spattering might also be caused by worn packing washers, or worn or scored needle.
- D. AN ARCHED FAN SPRAY PATTERN** is caused by dried material accumulated in one fan port of the fan aircap, distorting the pattern.
TO CORRECT: Dissolve material inside fan port with suitable water/solvent applied with a small brush.
Never use wire or sharp instruments to clean fan ports as permanent damage to the air ports will result in altering uniformity of the fan spray pattern.
- E. UNBALANCED FAN SPRAY PATTERN**, heavy on one side, may be caused by material collecting around outside of the fluid tip and aircap, or by a loose aircap.
TO CORRECT: Remove aircap and clean fluid tip and aircap with water/solvent, dry with air pressure. Always be sure fan aircap and aircap body is tightened securely.
- F. A HEAVY CENTER** in a fan pattern is caused by insufficient air pressure at the fan port. Rough or shady edges are also caused by low air pressure.
TO CORRECT: Increase air line pressure.
- G. A SPLIT FAN SPRAY PATTERN**, heavy on each end and light in the center, is caused by excessive air pressure.
TO CORRECT: Reduce air pressure.

SPRAY PATTERNS:



Paasche Airbrush Company
4311 North Normandy Avenue
Chicago, IL 60634-1395
Phone: 773-867-9191 • **Fax:** 773-867-9198
Website: paascheairbrush.com
E-Mail: info@paascheairbrush.com

Spray Heads for **CU-** Manual Spray Guns are available in several different styles, some of which are available with Stainless Steel components. The C.F.M. requirements range from 3 to 24 C.F.M. @ 40 to 50 lbs. air pressure. **NOTE:** When either fluid Tip or fluid Needle is worn and requires replacement, it is recommended that both items be changed for best results. All Tips and Needles are made using 303 Stainless Steel. Carbide Tips & Needles are available for use with abrasive materials.

EXTERNAL- FAN PATTERN

- **Application:** Broad coverage - High Production.
- **Sizes:** 000-3, 00-4, 00-4-6, 06, 0-9, 2-8, 4-10, 4-15.
- **Fluid Viscosity:** Light to Heavy (3 to 24 C.F.M. @ 40 or 50 P.S.I.)
 1. **56FA-** Aircap Body (Select Size above)
 2. **U-2639S** Sleeve & Spring
 4. **U-1649** Aircap Nut
 5. **U-** Stainless Tip (Select Size 000,00,0,2,4)
 6. **U-2-3/8** Stainless Needle

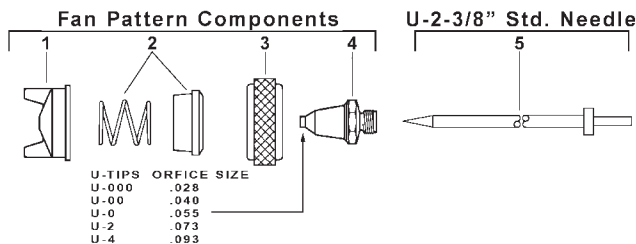

INTERNAL- ROUND PATTERN

- **Application:** Narrow trim, inside crevice, dot, line, High Production.
- **Sizes:** 2-5, 4-6.
- **Fluid Viscosity:** Light to Medium (3 to 6 C.F.M. @ 40 P.S.I.)
 1. **56RA-** Aircap Body (Select Size above)
 2. **U-1649** Aircap Nut
 3. **U-** Stainless Tip (Select Size 2 or 4)
 4. **U-2-3/8** Stainless Needle

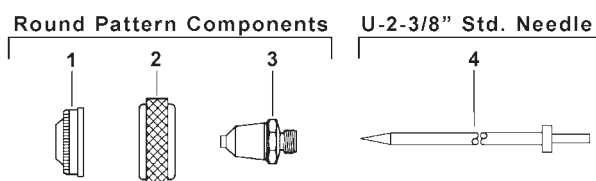

CARBIDE INSERT- FAN PATTERN

- **Application:** Abrasive Materials
- **Sizes:** 0-9, 2-8 or 4-10
- **Fluid Viscosity:** Light to Medium (4 to 12 C.F.M. @ 40 or 50 P.S.I.)
 1. **56CFA-** Aircap Body (Select Size above)
 2. **U-2639S** Sleeve & Spring
 3. **U-1649** Aircap Nut
 4. **UC-** Carbide Insert Stainless Body Tip (Select Size 0, 2 or 4)
 5. **UC-2-3/8** Carbide Insert Stainless Needle

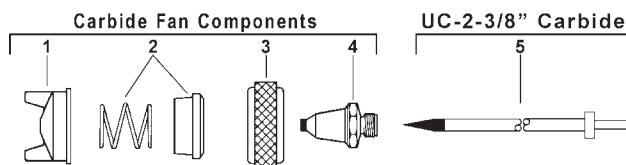

CARBIDE INSERT- ROUND PATTERN

- **Application:** Abrasive Materials
- **Sizes:** 2-5 & 4-6
- **Fluid Viscosity:** Light to Medium (3 to 6 C.F.M. @ 40 P.S.I.)
 1. **56CRA-** Aircap Body (Select Size above)
 2. **U-1649** Aircap Nut
 3. **UC-** Carbide Insert Stainless Body Tip (Select Size 2 or 4)
 4. **UC-2-3/8** Carbide Insert Stainless Needle

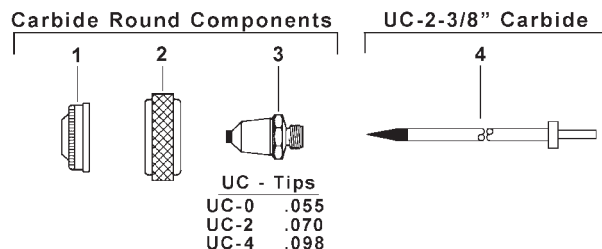

STAINLESS STEEL- FAN PATTERN

- **Application:** Corrosive materials and Latex.
- **Sizes:** 0-6, 0-9, 2-8, 4-10, 4-20-3.
- **Fluid Viscosity:** Light to Medium Heavy (4 to 20 C.F.M. @ 40 or 50 P.S.I.)
 1. **56SFA-** Stainless Aircap Body (Select Size above)
 2. **U-2639P** Poly Sleeve
 3. **U-1649** Aircap Nut (plated brass)
 4. **U-** Stainless Tip (Select Size 0, 2 or 4)
 5. **U-2-3/8** Stainless Needle

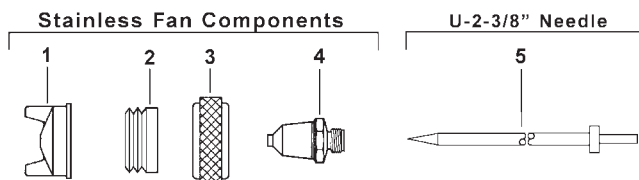

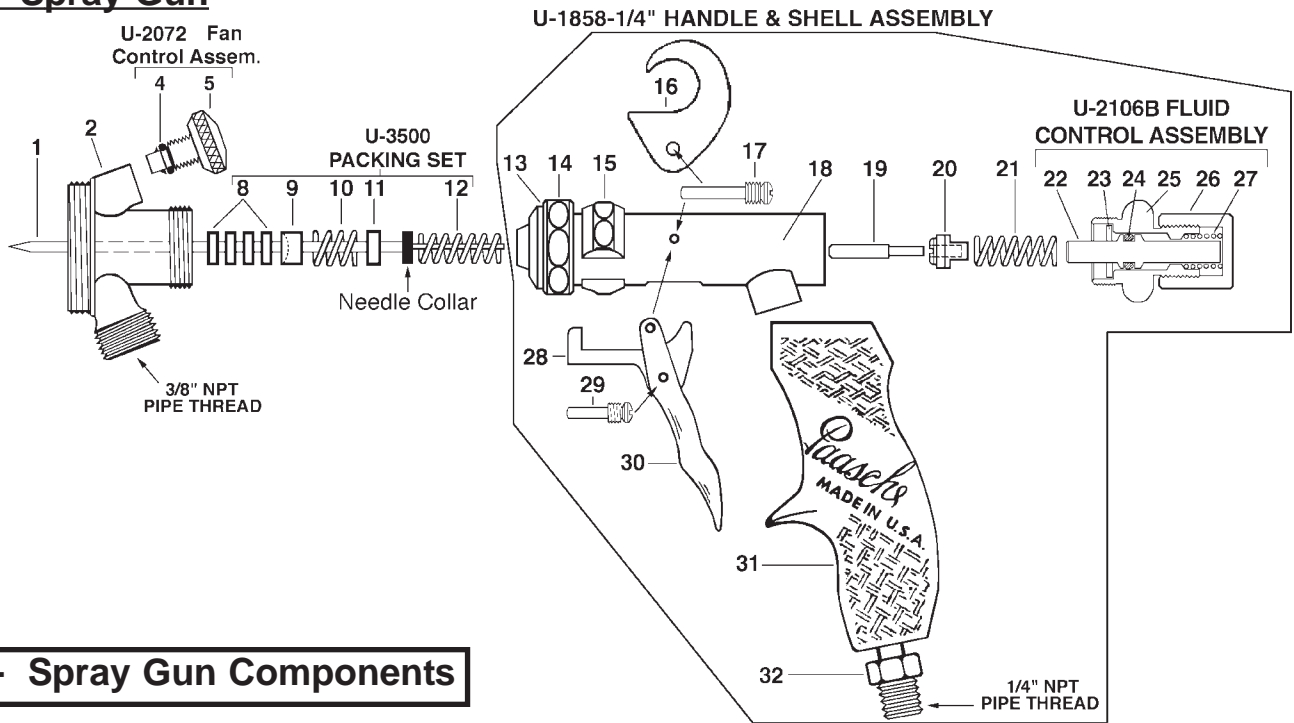

CU- Spray Gun Components

No.	Part No.	Description
1.	U-2-3/8	Needle
2.	CU-7B	Fluid Body

U-2072 FAN CONTROL ASSEMBLY

4.	AE-43	"O" Ring
5.	U-2065	Fan Control Screw

U-3500 PACKING ASSEMBLY

8.	U-28-12	Packing Washers (1 Doz.)
9.	U-29	Packing Gland (1)
10.	DU-30	Spring (1)
11.	U-31	Spring Seat (1)
12.	U-33	Spring (1)

U-1858-1/4 HANDLE & SHELL ASSEMBLY

13.	U-2153	Retaining Ring
14.	U-58Nut	
15.	U-755	Link Sleeve
16.	U-828	Hook
17.	U-856	Screw
18.	U-2154A	Shell Assembly
19.	U-762	Air Valve Piston
20.	U-2520P	Air Valve Head
21.	U-2500	Spring

U-2106B FLUID CONTROL ASSEMBLY

22.	U-2631	Plunger
23.	U-2750	Packing Gland
24.	AE-43	"O" Ring
25.	U-2069B	Rear Cap
26.	200-17	Fluid Knob
27.	U-1702	Valve Spring

28.	U-1322A	Link Sleeve
29.	U-35	Trigger Link Screw
30.	U-1671	Trigger
31.	U-1890P	Durable Plastic Handle
32.	U-807	Air Inlet Tube Assembly



No.	Part No.	Description
-----	----------	-------------

59-28 TEFLON PACKING ASSEMBLY

32.	U-3353	Packing (Teflon®)
33.	59-24	Packing (Teflon®) (2)
34.	59-25B	Expander Gland
35.	DU-30	Spring

OPTIONAL TIPS & NEEDLES

1. URE-00, 0, 2 or 4 Tip (Select Size)
2. URE-1-17/32 Needle
Rear needle seat for Heavy Pigments that would collect and clog in the cavity of the standard tip.



3. US-0, 2 or 4 Self Cleaning Tip (Select) (US-0 same as U-0)
4. US-0-2-3/8 Self Cleaning Needle
US-2-2-3/8
US-4-2-3/8

Use to prevent buildup at tip orifice & pressure feed.

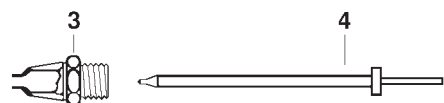

CAM-LOCK & SCREW COVER CUP ASSEMBLIES

CL-38 QT. CAM-LOCK

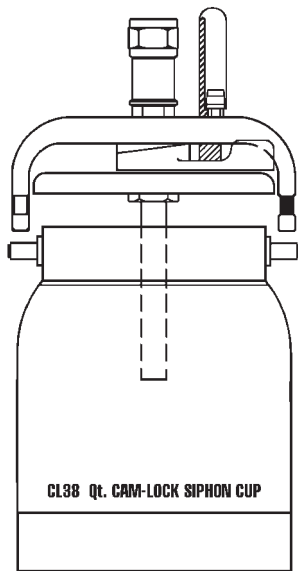

30SC QT. CUP ASSEM.
&
34SC 1/2 PT. CUP ASSEM.

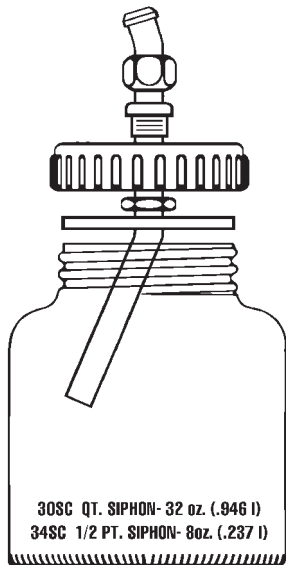

52P QT. CUP ASSEM.
Gun Not Included

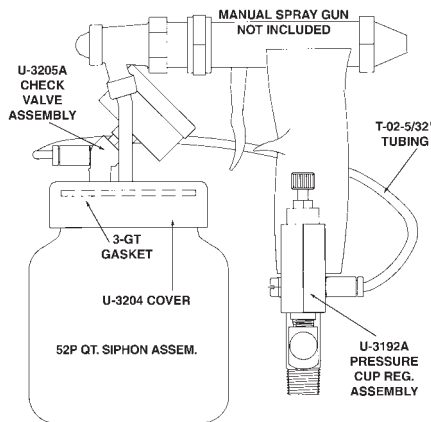

CU- FLUID BODIES

(See picture below)

1. **CU-7B** Forged Brass
CUS-7B Stainless Steel
2. **CUA-7B** Separate Air Atomizing Inlet - Brass
CUSA-7B Separate Air Atomizing Inlet - Stainless St.
3. **CUG-7B** Circulating Fluid Body - Brass

NOTE: U-28-12 and DU-28-12 Packing Washers only sold by the dozen.
© DuPont

1. **CU-7B**
CUS-7B

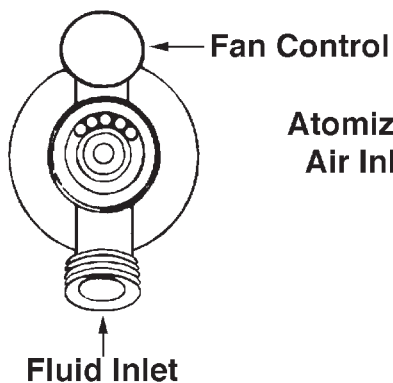

2. **CUA-7B**
CUSA-7B

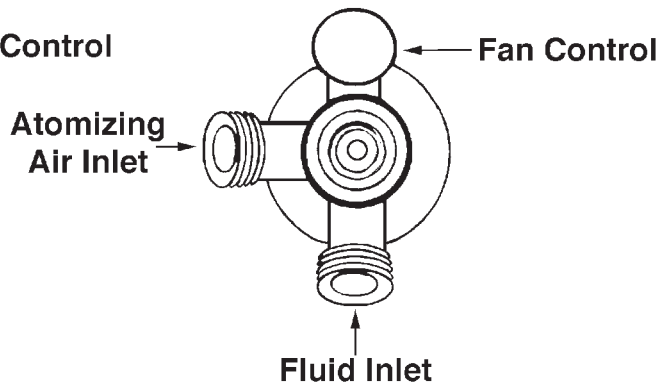

3. **CUG-7B**

