



BUS2RS and BUS2FS DUAL FLUID SPRAY GUNS

OPERATING INSTRUCTIONS AND REPLACEMENT PARTS

WARNING: Spray materials may be harmful if inhaled or allowed to come into contact with skin or eyes. Consult the product label and Material Safety Data Sheet supplied for the spray material. Follow all safety precautions. **CAUTION:** Well Ventilated Area Required to remove fumes, dust or overspray. Check compatibility of materials used with Polyethylene container and PVC Fluid Hose. Secure airhose and fluid hose wrench tight for safety and to prevent leaks.
Maximum Air Pressure 60 P.S.I.
Maximum Fluid Pressure 45 P.S.I.

INTRODUCTION:

These Manual Spray Guns require clean dry air pressure regulated to provide from 6 to 8 C.F.M. at 40 to 60 lbs. air pressure depending on size and number of atomizing heads to be used. Paasche Regulator & Condenser Units are recommended for attaching to air supply line to remove water, oil, rust or scale and help insure quality finish of coating. They have no parts that require replacement and clean themselves each time the drain valve is opened to remove accumulation of filtered contaminants.

AIR AND FLUID CONNECTIONS:

1. Air Connection: To remove any accumulated foreign matter blow out all hoses before using.
 - a. Air supply to Spray Gun must be turned off before attaching fittings to the Air Inlet.
 - b. Attach HT-1/4 Air Hose to the Air Outlet on the Air Regulator and Air Inlet on the bottom of the handle on the Spray Gun.
2. Fluid Hose Connection: HPT-1/4 PVC Fluid Hose with HPTSC-Stainless Steel Couplings should be long enough to form a loop below the Spray Gun at all times when using fluid hose to feed material to the Spray Gun (two required).
 - a. Attach HPTSC-1/4 St. St. Couplings to the fluid inlets of the two Fluid Bodies.
 - b. Attach opposite ends, HPTSC-1/4-3/8 St. St. Couplings, to containers of respective materials being sprayed.
3. Fluid Container Connection: When using USP-QT (QT/.946 I) Plastic Bottle Assemblies, make sure Screw Covers are tightened securely so fluid will not leak at Bottle connections.
4. Tighten all Air and Fluid connections securely.

OPERATION:

1. After hose connections have been made, regulate the air pressure to about 40 lbs. atomizing pressure and then pull trigger back slowly.
 - a. The first 1/4" of trigger stroke opens the Air Valve which operates the cylinder action of the right side atomizing components.
 - b. Continued pull on the trigger opens both of the atomizing Spray Heads for spraying.
2. The U-1460 Adjusting Nut (part 39) can be used to regulate desired amount of fluid to the automatic Spray Head and the 200-17 Fluid Knob (part 27) can be used to adjust fluid to the manual side of the two headed spray gun.
3. Dual Fluid Spray Guns are designed to atomize and mix fluid materials outside the atomizing aircaps. This prevents materials from hardening inside the spray gun.
4. The U-28-12 Packing Washers (part 6) should be replaced periodically.
 - a. Fill packing cavity with 3 new U-28-12 Packing Washers and replace U-29 Packing Gland (part 7), DU-30 Spring (part 8) and U-31 Spring Seat (part 9) in position.
 - b. A few drops of oil should occasionally be applied to the U-2506 Piston Leather (part Z) to keep it pliable.

Paasche Airbrush Company

4311 North Normandy Avenue

Chicago, IL 60634-1395

Phone: 773-867-9191 • Fax: 773-867-9198

Website: paascheairbrush.com

E-Mail: info@paascheairbrush.com

- 1A. **BSF-15-0** Stainless Fan Aircap
- 2. **BUS-12** Stainless Aircap Nut
- 3. **U-0** Stainless Tip
- 4. **U-2-3/8** Stainless Needle
- 4A. **A-U-3-1/32** Stainless Needle (Fig. E Cylinder Action)

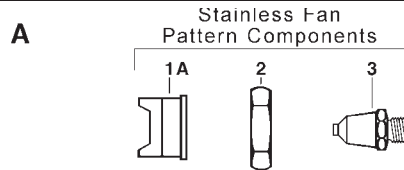

- 1. **BSR-15-2 or 4** Stainless Aircap(Select Size)
- 2. **BUS-12** Stainless Aircap Nut
- 3. **U-2 or 4** Stainless Tip (Select Size)
- 4. **U-2-3/8** Stainless Needle
- 4A. **A-U-3-1/32** Stainless Needle (Fig. E Cylinder Action)

- 5. **BUS2-7B** Stainless Fluid Body
- 6. **U-28-12** Packing Washers (4) †
- 7. **U-29** Packing Gland (1) †
- 8. **DU-30** Spring • (1) †
- 9. **U-31** Spring Seat (1) †
- 10. **U-33** Spring • (1) †
- 11. **U-58** Nut •
- 12. **U-2153** Retaining Ring
- 13. **U-755** Link Sleeve
- 14. **U-828** Hook
- 15. **U-2154A** Shell Assembly
- 16. **U-1322A** Link Assembly •
- 17. **U-856** Trigger & Hook Screw •
- 18. **U-35** Trigger Link Screw •
- 19. **U-1671** Trigger •
- 20. **U-762** Air Valve Piston •
- 21. **U-2520P** Air Valve Head
- 22. **U-2500** Spring •

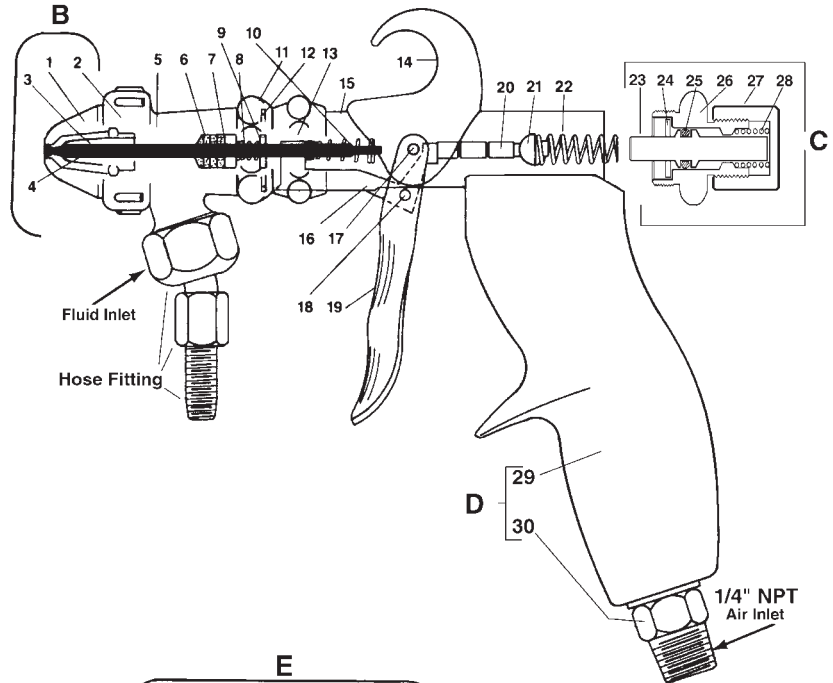

C. U-2106B Fluid Control Assembly

- 23. **U-3631** Plunger
- 24. **U-2750** Packing Gland
- 25. **AE-43** "O" Ring
- 26. **U-2069B** Rear Cap
- 27. **200-17** Fluid Cap
- 28. **U-1702** Valve Spring

D. U-2108 Handle Assembly

- 29. **U-1890P** Handle Blue (PP)
- 30. **U-807** Air Inlet Tube Assembly

- 33. **BUS2R-7B** St. St. Fluid Body •
- 6. **U-28-12** Packing Washers (4)
- 7. **U-29** Packing Gland (1)
- 8. **DU-30** Spring • (1)

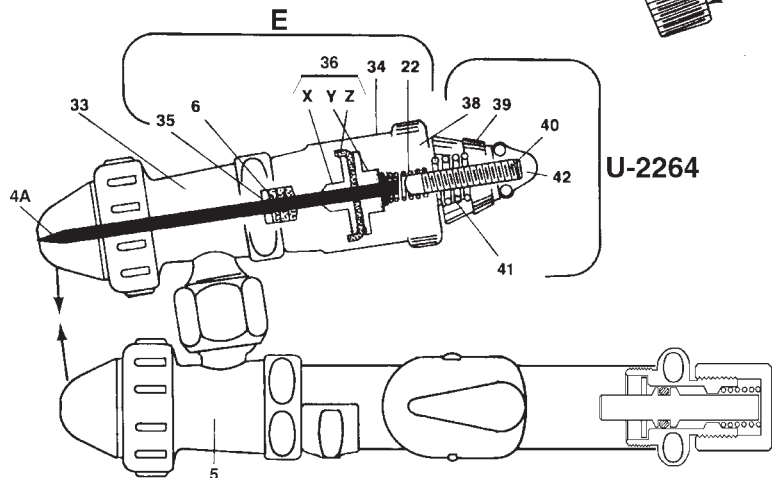

E. U-2260 Cylinder Assembly

- 34. **U-2493** Cylinder Shell Assembly
- 4A. **A-U-3-1/32** Needle •
- 35. **U-203** Packing Gland (1)
- 6. **U-28-12** Packing Washers (3)
- 36. **U-2505** Piston Assembly
- X. **U-2503** Small Piston Disc
- Y. **U-2504** Large Piston Disc
- Z. **U-2506** Piston Leather
- 22. **U-2500** Spring •

U-2264 Rear Cap Assembly

- 38. **U-2265** Rear Cap (Only)
- 39. **U-1460** Adjusting Nut
- 40. **U-3549** Needle Stop •
- 41. **U-3352** Spring •
- 42. **U-1495** Locknut

F. USP-QT (QT./946 I) Plastic Bottle Assembly

- 43. **U-2651** Washer (Tygon)
- 44. **U-3544** St. St. Washer •
- 45. **U-2648** Locknut •
- 46. **U-2179-9-1/2** Tube & Bushing Assembly •
- 47. **U-3520** Quart Poly Bottle
- 48. **UP** Poly Cover
- 49. **NAS-3/8** St. St. Nut •
- 50. **U-2647** Bushing •

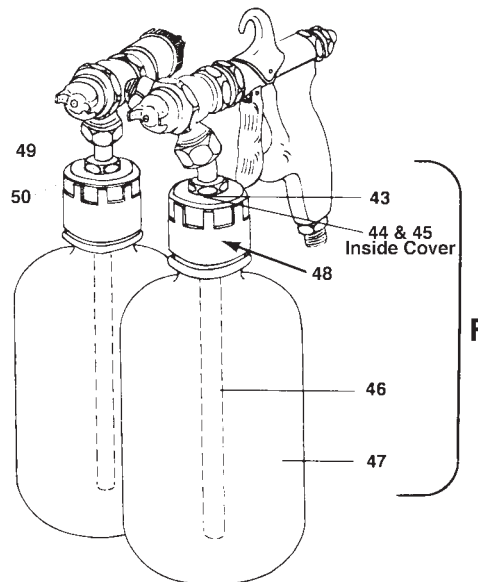

NOTE:

U-3500 Packing Set includes items marked †
U-28-12 Packing Washers sold by the Dozen only.
 • This Symbol denotes items made of Stainless Steel.