



BUHF- High Volume Low Pressure Manual Spray Gun

OPERATING INSTRUCTIONS & REPLACEMENT PARTS

WARNING: Spray materials may be harmful if inhaled or allowed to come into contact with the skin or eyes. Consult the product label and Material Safety Data Sheet supplied for the spray material. Follow all safety precautions.
CAUTION: Well Ventilated Area Required to remove fumes, dust or overspray. Secure airhose and fluid hose wrench tight for safety and to prevent leaks.
Maximum Controlled Line Air Pressure 50 P.S.I.
Maximum Fluid Pressure 45 P.S.I.

DESCRIPTION:

BUHF- Manual Spray Gun is for use with Light to Medium consistency materials. Best spray results are achieved using pressure fluid feed, although gravity and siphon cups can also be used. These models require 3 to 10 C.F.M. @ 20 to 50 P.S.I. air pressure depending on size of Spray Head Components selected and material being sprayed.

SPECIAL NOTE: HVLP Spray Head with U-3609 Air Inlet Tube required for High Volume Low Pressure operation.

AIR CONNECTIONS:

This model has 1/4" N.P.T. Air Inlet.

1. Open air control valve and blow out Air Hose to remove any foreign particles that may be in airline. Secure air hose so it doesn't injure anyone during purging.
2. Connect air hose to U-3609 Air Inlet Tube on the **BUHF-** Bottom Air Inlet Model.

FLUID CONNECTIONS:

This model has 3/8" N.P.T. Fluid Inlet.

1. For Siphon Feed, attach siphon feed cup to bottom inlet of Fluid Body Assembly.
2. For Gravity Feed, loosen U-58 Nut and then turn fluid inlet of Fluid Body Assembly to top of Spray Gun and connect Gravity Feed Cup. Tighten U-58 Nut.
3. Pressure Fluid feed operation requires that you attach one end of fluid hose to approved ASME pressure tank and the other end to the fluid inlet on the Fluid Body Assembly (Recommended Method).

MATERIAL:

1. Mixture should be to the consistency recommended by the manufacturer.
2. Strain all materials through a cloth or fine wire mesh prior to using to insure all foreign particles have been removed.

SPRAY HEAD:

1. Spray Head (Fan Pattern) (**HIGH VOLUME LOW PRESSURE**) has maximum head pressure of 10 P.S.I. when controlled line pressure does not exceed 50 P.S.I. and requires the use of a **U-3609** Inlet Tube.

OPERATION:

Adjust 200-17 Fluid Knob on **BUHF-** (Bottom air inlet) Models to regulate the flow of material through the Spray Gun.

Grip Spray Gun as you would a pistol, place two fingers on the trigger. The first one quarter inch pull releases air only and is used for cleaning by dusting surfaces before painting. Continued pull on the trigger retracts the Fluid Needle and allows maximum fluid passage.

Begin Painting by applying as light a coat as possible. Take long strokes from side to side releasing the trigger at the end of each stroke. For average work, hold head of Spray Gun 6 to 8 inches from the surface; for narrow lines, use short trigger pull and hold Spray Gun closer to the surface. To get wider spray patterns, draw Spray Gun away from surface gradually while trigger is pulled back until desired width of pattern is obtained. Practice before spraying on your project is always advisable.

CARE AND CLEANING:

Flush clean solvent through the fluid passages of the Spray Gun and wipe off the outside. Never leave the entire Spray Gun immersed in solvent or the leather packings will dry out. Dirty Aircaps and Tips should be cleaned out by soaking in solvent and then blown clean with air. Never use wire objects to ream out the holes in aircaps or tips as this will damage these items. Always follow safety instructions on cleaning solvents being used and remember to keep your containers closed in a safe location.

BUHF- Manual Spray Gun High Volume Low Pressure

U-1858-1/4" HANDLE AND SHELL ASSEMBLY

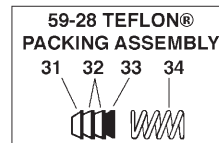
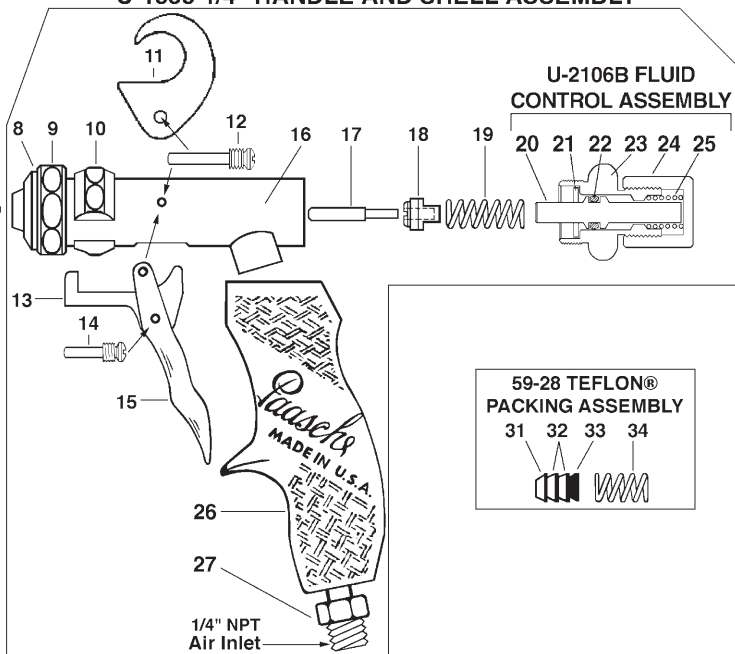
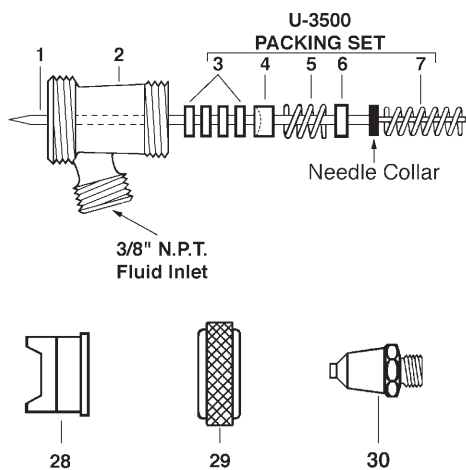

BUHF- (HVLP) Spray Gun Components

No. Part No. Description

1. **U-2-3/8** Needle (Not included on UH-1858-1/4)
2. **BU-7B** Fluid Body

U-3500 Packing Set

3. **U-28-12** Packing Washers (4)
4. **U-29** Packing Gland
5. **DU-30** Spring
6. **U-31** Spring Seat
7. **U-33** Spring

UH-1858-1/4 Handle & Shell Assembly

8. **U-2153** Retaining Ring
9. **U-58** Nut
10. **U-755** Link Sleeve
11. **U-828** Hook
12. **U-856** Trigger & Hook Screw
13. **U-1322A** Link Assembly
14. **U-35** Trigger Link Screw
15. **U-1671** Trigger
16. **U-2154A** Shell Assembly
17. **U-762** Air Valve Piston
18. **U-2520P** Air Valve Head
19. **U-2500** Spring

U-2106B Fluid Control Assembly

20. **U-2631** Plunger
21. **U-2750** Packing Gland
22. **AE-43** "O" Ring
23. **U-2069B** Rear Cap
24. **200-17** Fluid Knob
25. **U-1702** Valve Spring

26. **U-1890P** Plastic Handle (Polypropylene)
27. **U-3609** Air Inlet Tube (Required on BUHF-Model)

HVLP- EXTERNAL FAN PATTERN

- Sizes: 000, 00, 0 or 2

28. **BFHA-** Fan Aircap (Select Size)
29. **BU-12** Aircap Nut
30. **U-** StainlessTip (Select Size)

59-28 Teflon® Packing Assembly (Optional)

31. **U-3353** Packing Teflon® (1)
32. **59-24** Packing Teflon® (2)
33. **59-25B** Packing Expander (1)
34. **DU-30** Spring

Special Tips & Needles

- **US-2** or **4** Self Cleaning tip § (Select Size)
 - **US-2-2-3/8** Self Cleaning Needle § (Match Tip Size)
 - **US-4-2-3/8** (Match Tip Size)
- Self Cleaning feature clears tip orifice every time needle is pulled back for spraying.

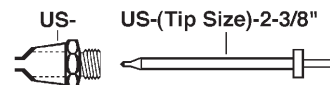

CONTAINERS: 47SCJ, 30SC, 31SC, 34SC, 35SC and 50P, other sizes available - Bulletin C & B.

