



# AUB- (Bottom Air Inlet) AUT- (Thumb Action) Manual Spray Guns

## OPERATING INSTRUCTIONS AND REPLACEMENT PARTS

### DESCRIPTION:

The AUB- Series Manual Spray Guns can be used with light to medium consistency materials for touch-up, shading and finishing of small parts. They can cover a range of materials to include light lacquers, latex or corrosives. **When using Extensions, material must be pressure fed for proper application.**

### AIR AND FLUID CONNECTIONS:

Air Inlet 1/4" N.P.T. (M) and Fluid Inlet 1/4" N.P.T. (M).

**PACKING WASHERS** are leather and treated in oil. For Teflon® Packings see parts list Page 3.

### OPERATION:

1. Before using, blow out air hoses with compressed air to remove foreign particles.
2. Connect airhose to U-49A Valve Casing for type **AUT-** (Thumb-Action) Spray Gun and U-807 for type **AUB-**.
3. Keep connections tight, any leakage of air will impair operation of Spray Gun and waste air pressure.
4. **Siphon Cup:** Attach Cup to the fluid body assembly when 1/4" N.P.T. threaded inlet is in the down position.
5. **Gravity Cup:** Loosen U-58 Nut and turn fluid body inlet to the top of Spray Gun; tighten U-58. A gravity feed cup will feed fluid approximately 30% faster than a siphon feed cup. This permits detail work with head of spray gun close to the work surface (cup on top) .
6. **Pressure Tank:** When fluid hose is coupled directly to fluid inlet of Spray Gun, HA-1/4 Fluid Hose with HAC-1/4 and HAC-1/4-3/8 Couplings should be ordered. Attach HAC-1/4-3/8 Coupling to fluid outlet of tank.
7. To control Fluid: **AUB- (Bottom Air Inlet)** adjust 200-17 Fluid Knob. **AUT- (Thumb-Action)** adjust the U-1816 Adjusting Screw.
8. A fan is used for broad patterns. Stipple effects can be obtained by reducing atomizing pressure until dots are produced.
9. A round pattern is used for narrow work, stippling, stenciling and shading.
10. As width of pattern increases flow of material must be increased proportionately to obtain fast coverage of larger areas. By proper adjustment, patterns up to 6", may be obtained with size 3 Spray Head Components.
11. Grip Spray Gun like a pistol placing two fingers on the trigger. The first one-quarter pull releases air only, this can be used for cleaning and dusting surfaces before painting. Continued pull on the trigger opens the fluid needle and a full wide fan pattern can be achieved.

**WARNING:** Spray materials may be harmful if inhaled or allowed to come into contact with the skin or eyes. Consult the product label and Material Safety Data Sheet supplied for the spray material. Follow all safety precautions.  
**CAUTION:** Well Ventilated Area Required to remove fumes, dust or overspray. Secure airhose and fluid hose wrench tight for safety and to prevent leaks.  
**Maximum Air Pressure 100 P.S.I.**  
**Maximum Fluid Pressure 45 P.S.I.**

12. Begin painting with as light a coat as possible. Take long strokes from side to side, releasing trigger at the end of each stroke. Check to make sure each stroke meets without much overlapping which can cause material to run. For general painting hold the Spray Gun with head approximately 2" to 6" from the surface. For narrow lines, approximately 1" to 2", use a short trigger pull and hold Spray Gun close to surface. To obtain a wider spray, pull trigger back while gradually drawing the head of the gun away from surface until desired width of pattern is reached.

### TROUBLE SHOOTING SPRAY PATTERNS:

- A. A ROUGH OR STIPPLE FINISH** is due to low or restricted flow of air pressure or heavy materials being applied with the spray gun too close to surface.
- B. A WET OR SAGGING FINISH** is due to low air pressure or restricted flow of air, material being too thin or applied too close to the surface.
- C. A SPATTERING SPRAY** is caused by air leaking into fluid line or can be caused by a loose fluid tip, a broken or split tip, lumpy material, a clogged vent hole in cover of material cup, air leak at fluid pipe attached to inside of tank cover, or a clogged paint strainer.  
**TO CORRECT:** Tighten tip securely or replace. Strain material and clean strainer. Spattering might also be caused by worn packing washers, or worn or scored needle.
- D. AN ARCHED FAN SPRAY PATTERN** is caused by dried material accumulated in one fan port of the multiplehead, distorting the pattern.  
**TO CORRECT:** Dissolve material inside fan port with suitable water/solvent applied with a small brush.  
**Never use wire or sharp instruments to clean fan ports as permanent damage to the air ports will result in altering uniformity of the fan spray pattern.**
- E. UNBALANCED FAN SPRAY PATTERN**, heavy on one side, may be caused by material collecting around outside of the fluid tip and aircap, or by a loose aircap.  
**TO CORRECT:** Remove aircap and clean fluid tip and aircap with water/solvent, dry with air pressure. Always be sure fan aircap and aircap body is tightened securely.
- F. A HEAVY CENTER** in a fan pattern is caused by insufficient air pressure at the fan port. Rough or shady edges are also caused by low air pressure.  
**TO CORRECT:** Increase air line pressure.
- G. A SPLIT FAN SPRAY PATTERN**, heavy on each end and light in the center, is caused by excessive air pressure.  
**TO CORRECT:** Reduce air pressure.

### SPRAY PATTERNS:



**Paasche Airbrush Company**  
4311 North Normandy Avenue  
Chicago, IL 60634-1395  
Phone: 773-867-9191 • Fax: 773-867-9198  
Website: [paascheairbrush.com](http://paascheairbrush.com)  
E-Mail: [info@paascheairbrush.com](mailto:info@paascheairbrush.com)

Spray Heads for the AUB & AUT Manual Spray Guns are available in several different styles, some of which are available with Stainless Steel components. The C.F.M. requirements range from .25 to 3 C.F.M. @ 30 lbs. air pressure. NOTE: When either fluid Tip or fluid Needle is worn and requires replacement, it is recommended that both items be changed for best results. All Tips and Needles are made using 303 Stainless Steel. Carbide Tips and Needles are available for use with abrasive materials.

- **Sizes:** 000/0, 1, 2 or 3
- **Application:** General Light Painting, Touch-up and Decorating
- **Fluid Viscosity:** Light
- **Atomization:** External - Fan, Internal - Round

#### EXTERNAL - FAN PATTERN

1. **ANFA-** Fan Aircap (Select Size above)
- 1A. **ANFAS-** Stainless Fan Aircap (Select Size above)
2. **AU-12** Aircap Nut
- 2A. **AUS-12** Stainless Aircap Nut (Optional)
3. **AU-** Stainless Tip (Select Size above)
4. **AU-2-1/16** Stainless Needle
- AUT-2-7/32** Stainless Needle (Thumb-Action Spray Gun AUT)

#### INTERNAL - ROUND PATTERN

5. **AARC-1** Aircap Body for AAR- (Internal Round)
6. **AR-15-** Round Aircap - (Select Size above)
- 6A. **ASR-15-** Stainless Round Aircap - (Select Size above)
7. **AU-12** Aircap Nut
- 7A. **AUS-12** Stainless Aircap Nut
8. **AU-** Stainless Tip (Select Size above)
9. **AU-2-1/16** Stainless Needle
- AUT-2-7/32** Stainless Needle (Thumb-Action Spray Gun AUT)

#### INTERNAL MIX- FAN PATTERN

- **Sizes:** 1 only
  - **Application:** Broad Coverage
  - **Fluid Viscosity:** Light
  - **Application:** Fluid pressure must be approximately 5 to 10 P.S.I. lower than air atomizing pressure.
10. **ASC-1** Slotted Cap
  11. **AU-6** Cap Nut
  12. **ARA-1** Aircap Body
  13. **AU-12** Aircap Nut
  14. **AU-1** Stainless Tip
  15. **AU-2-1/16** Stainless Needle
  - AUT-2-7/32** Stainless Needle (Thumb-Action Spray Gun AUT)

#### CARBIDE INSERT- FAN PATTERN

- **Size:** 4 Only
  - **Application:** Gritty and Abrasive Material
  - **Fluid Viscosity:** Light Abrasives
16. **ANFAC-4** Fan Aircap (for Carbide Tip)
  17. **AU-12** Air Cap Nut
  18. **AUC-4** Carbide Insert Stainless Fluid Tip
  19. **AUC-2-1/16** Carbide Insert Stainless Needle

#### CARBIDE INSERT- ROUND PATTERN

- **Size:** 4 Only
  - **Application:** Gritty and Abrasive Material
  - **Fluid Viscosity:** Light Abrasives
20. **ACR-15-4** Aircap
  21. **AU-12** Aircap Nut
  22. **AUC-4** Carbide Insert Stainless Fluid Tip
  23. **AUC-2-1/16** Carbide Insert Stainless Needle

#### AURE TIP- SPECIAL APPLICATION

- **Application:** May be used in conjunction with Fan or Round pattern Heads. For application of fast settling materials, Needle Seat is in the rear, which prevents material from settling in the Tip cavity.
24. **AURE-3** Stainless Tip
  25. **AU-1-13/32** Stainless Needle

#### Fan Pattern Components

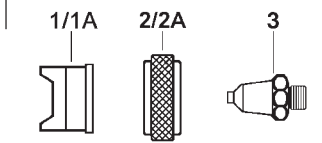

#### A-AU-3-11/16" Needle

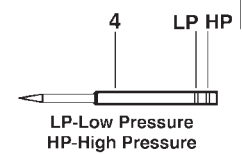

#### Round Pattern Components

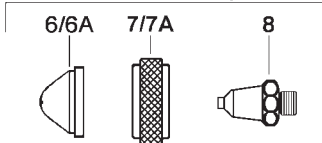

#### A-AU-3-11/16" Needle

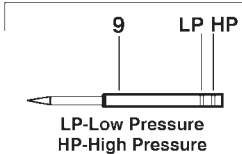

#### Internal Mix Components

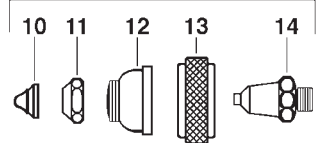

#### A-AU-3-11/16" Needle

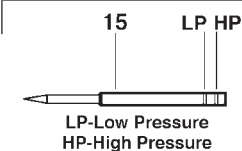

#### Fan Carbide Insert Components

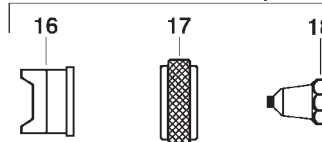

#### A-AUC-3-11/16" Needle Carbide Insert Needle

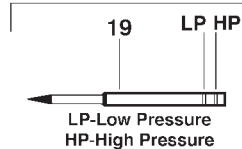

#### Round Carbide Insert Components

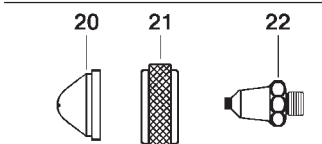

#### A-AUC-3-11/16" Needle Carbide Insert Needle

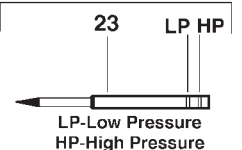

#### AURE- Tip and A-AU-3-3/64" Needle

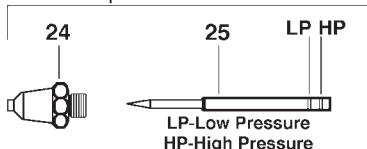

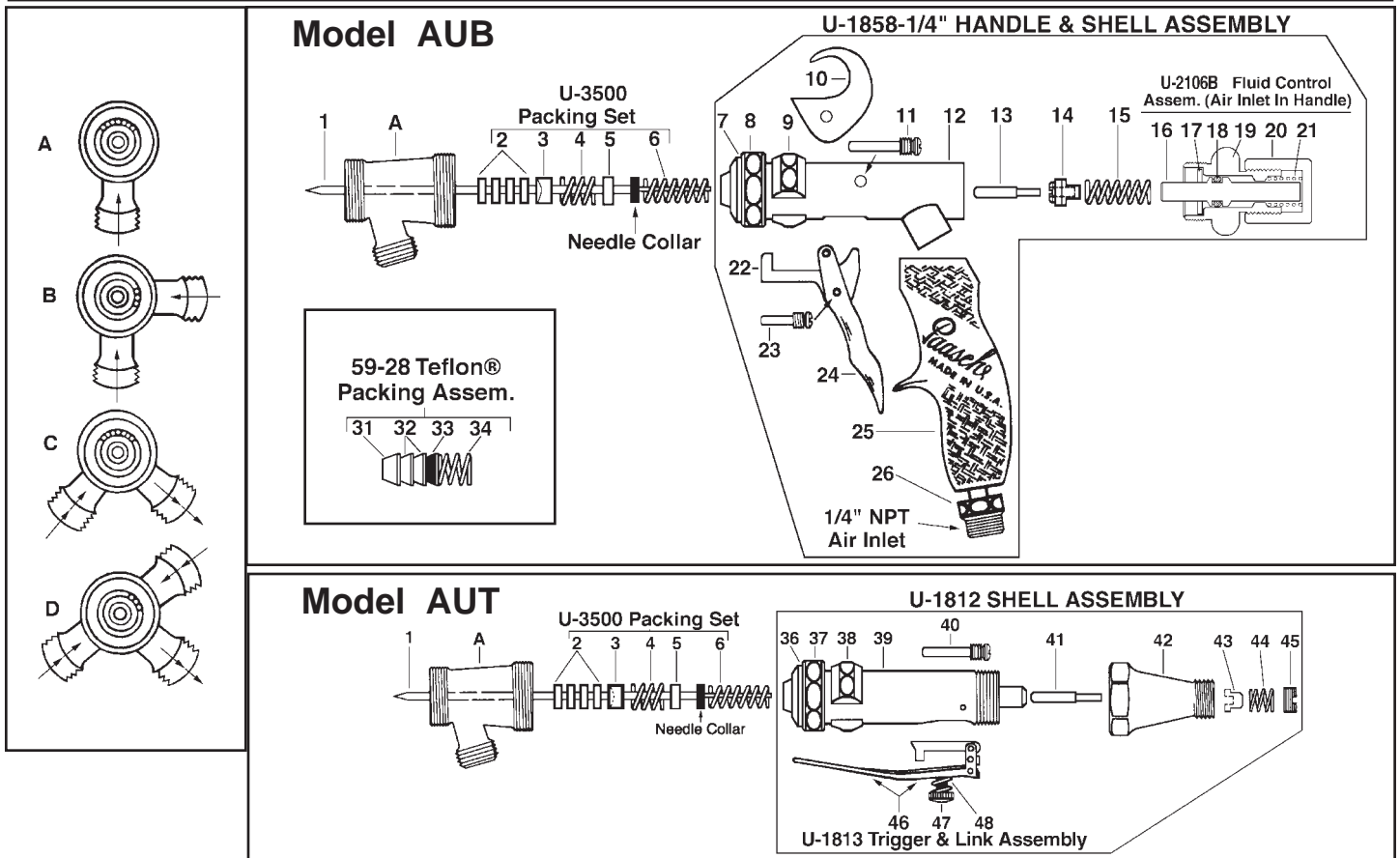

- 1. AU-2-1/16 Needle (use for AUB)
- AUT-2-7/32 Needle (use for AUT)
- A AU Fluid Bodies ( use for AUB and AUT)**
  - A. AU-7B Standard
  - AUS-7B Stainless Steel
  - B. AUA-7B Independent Atomizing
  - AUSA-7B Independent Atomizing Stainless Steel
  - C. AUG-7B Circulating Fluid
  - AUSG-7B Circulating Fluid Stainless Steel
  - D. AUAG-7B Circulating Fluid Separate Atomizing

**U-3500 Packing Set (use for AUB and AUT)**

- 2. U-28-12 Packing Washers (1 Doz.)
- 3. U-29 Packing Gland (1)
- 4. DU-30 St. St. Spring (1)
- 5. U-31 Spring Seat (1)
- 6. U-33 Spring (1)

**Model AUB**

**U-1858-1/4 Handle & Shell Assembly**

- 7. U-2153 Retaining Ring
- 8. U-58 St. St. Nut
- 9. U-755 Link Sleeve
- 10. U-828 Hook
- 11. U-856 Trigger & Hook Screw
- 12. U-2154A Shell Assembly
- 13. U-762 Air Valve Piston
- 14. U-2520P Air Valve Head
- 15. U-2500 Spring

**U-2106B Fluid Control Assembly**

- 16. U-3631 Plunger
- 17. U-2750 Packing Gland
- 18. AE-43 "O" Ring
- 19. U-2069B Rear Cap
- 20. 200-17 Fluid Knob
- 21. U-1702 Valve Spring

- 22. U-1322A St. St. Link Assembly
- 23. U-35 St. St. Trigger Link Screw
- 24. U-1671 St. St. Trigger
- 25. U-1890P Plastic Handle (Polypropylene)
- 26. U-807 Air Inlet Tube for AUB- Model

**Model AUT**

**U-1812 Shell Assembly (Thumb-Action Model )**

- 36. U-2153 Retaining Ring
- 37. U-58 St. St. Nut
- 38. U-755 Link Sleeve
- 39. U-1811 Shell
- 40. U-40 Trigger Screw
- 41. U-194 Air Valve Piston
- 42. U-49A Valve Casing
- 43. U-154P Air Valve Head
- 44. U-1853 Air Valve Spring
- 45. U-48 Strainer Nut

**U-1813 Trigger & Link Assembly**

- 46. U-193A Trigger & Link Assembly
- 47. U-1816 Adjusting Screw
- 48. U-1815 Trigger Stop Spring

**59-28 Teflon® Packing Set (Optional on all Spray Guns)**

- 31. U-3353 Teflon® Packing (1)
- 32. 59-24 Teflon® Packing (2)
- 33. 59-25B Expander Gland (1)
- 34. DU-30 Spring (1)

☒ U-28-12 and DU-28-12 Packing Washers Sold by the Dozen Only. © DuPont



Micro Extensions for coating inside small diameters. Will handle most light viscosity fluids. Pistol Grip Spray Gun uses **AU-1-13/32 Needle** and the Thumb Action Spray Gun uses **AUT-1-47/64 Needle**.

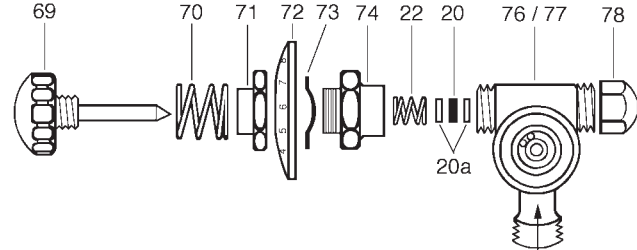
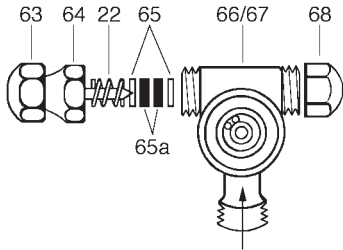

**Independent Atomizing Needle Valve Body (Also in Stainless Steel)**

- 63. **U-166A** Needle Valve Assembly
- 64. **U-167** Spring Cap
- 22. **DU-30** St. St. Spring
- 65. **U-203** Gland (2)
- 65a. **U-28-12** Packing Washers (2)
- 66. **AU-7DA** Fluid Body
- 67. **AUS-7DA** St. St. Fluid Body
- 68. **U-551** Cap Nut

**Atomizing Air Dial Control (Also In Stainless Steel)**

- 69. **U-959** Air Adjusting Needle
- 70. **U-1098** Spring
- 71. **U-942** Friction Nut
- 72. **PA-14** Dial
- 73. **U-941** Spring Washer
- 74. **U-957** Bushing
- 22. **DU-30** St. St. Spring
- 20. **DU-28-12** Packing Washers (1)
- 20a. **U-27** Packing Gland (2)
- 76. **AU-7DA** Fluid Body
- 77. **AUS-7DA** St. St. Fluid Body
- 78. **U-551** Cap Nut

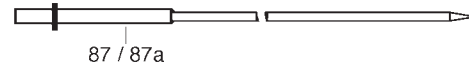
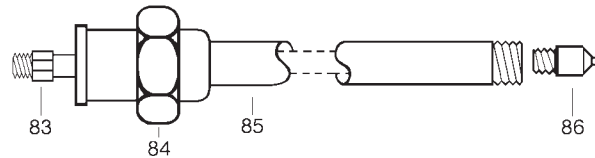
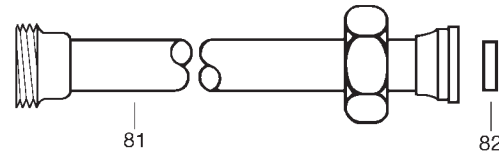
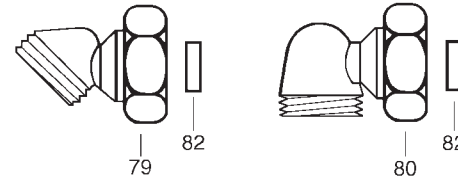

**AUB Accessories**

- 79. **AEN-45** 45° Elbow
- 80. **AEN-90** 90° Elbow
- 82. **AN** Nylon Washer
- 84. **AUF-29** Swivel Nut

**AE- Extensions (ANF- and AR- Heads Only)**

- Length Sizes: -3" -6" -12" -18" -24" -36" -48"
- 81. **AE-** Extension L/Needle (Select Size)

**AX- Stainless Steel Extensions (AX- Aircaps & Tips Only)**

- Length Sizes: -3 -6 -12 -18 -24 -36 -48
- 83. **U-2831-** St. St. Inner Tube (Select Size)
- 85. **U-2832-** St. St. Outer Tube (Select Size)

**AU- St. St. Extension Needles (AE- and AX- Extensions)**

- AU Length Sizes: -3" -6" -12" -18" -24" -36" -48"
- 87. **AU-** St. St. Extension Needle (Select Size)
- 87a. **AUT-** St. St. Extension Needle (AUT Only) (Select Size)
- AUT Length Sizes: -3 -6 -12 -18 -24 -36 -48

**AX- Style Tip and Aircaps (AX- Extension Only). These Aircaps require material pressure feed. Always adjust atomizing air pressure higher than fluid air pressure.**

- 86. **AX-1** Tip
- 88. **AXR** Aircap (External Round)
- 89. **AXF** Aircap (External Fan)
- 90. **AXIF** Aircap (Internal Fan)
- 91. **AXIF-90** Aircap (Internal Fan)
- 92. **AXIF-45** Aircap (Internal Fan)
- 93. **AXIB** Aircap (Spherical)
- 94. **AXI-360** Aircap (Radial Dial)
- 95. **AXIF-90A** Aircap (Internal Fan)
- 96. **AXIR-15** Aircap (Internal Round)
- 97. **AXIR-90** Aircap (Internal Round)

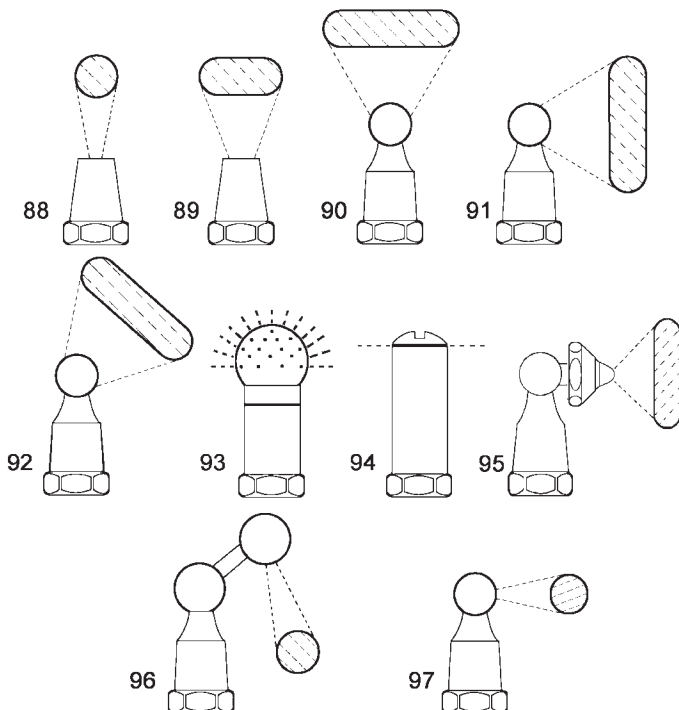

☒ U-28-12 and DU-28-12 Packing Washers sold by the Dozen.  
 ☒ Teflon® Needle Packing add X after AU. Example: AUXF-0.