



A-AU

Automatic Spray Gun

OPERATING INSTRUCTIONS AND REPLACEMENT PARTS

DESCRIPTION:

The A-AU Automatic Spray Gun, is a light duty air actuated production spray gun. It will cover a range of materials to include light lacquers, latex, acid or corrosives. **When using Extensions, material must be pressure fed for proper application.**

CONNECTIONS:

Connections to the gun are: Air Inlet 1/4" N.P.T. (F) and Fluid Inlet 1/4" N.P.T. (M). A-AU Automatic Spray Gun dimensions are: 5-1/8" (L) x 2-1/4" (D)

PACKING WASHERS:

Washers are made of leather and treated in oil. For Teflon® Packings see parts list, Page 3.

OPERATION:

1. Mount Gun in desired position
2. Before installing, blow out air hoses with compressed air to remove foreign particles.
3. Connect hose from air supply to air inlet fitting.
4. Connect fluid hose to fluid inlet supply.
5. Tighten all hose connections securely.
6. Adjust air pressure to 45-55 P.S.I. at the Air Regulator.
7. Adjust fluid volume by turning the U-3178 Fluid Adjusting Knob to the left or right.

NOTE: DO NOT USE U-3178 AS A SHUT-OFF BY TURNING ALL THE WAY DOWN - IT MAY SPLIT THE TIP.

TIP REMOVAL:

1. Turn off Air and Fluid Pressure.
2. Release Needle pressure from the seat of Tip, by backing off the U-3178 Fluid Adjusting Knob approximately 5 turns, then removing U-2686A Cylinder Cap Assembly.
3. Loosen AU-12 Aircap Nut and remove Spray Head Assembly. **Leave Needle In Place.**
4. Unscrew AU-Tip. Place New AU-Tip in position.
5. To replace, reverse above procedure.

MAINTENANCE:

Requirements of the A-AU Automatic Spray Gun have been reduced to a minimum. The leather packing washers should be lubricated once a month with a light oil. Old Packing Washers cause leakage of Air or Fluid and replacement should be made. Teflon® Packings are self-lubricating.

WARNING: Spray materials may be harmful if inhaled or allowed to come into contact with the skin or eyes. Consult the product label and Material Safety Data Sheet supplied for the spray material. Follow all safety precautions.
CAUTION: Well Ventilated Area Required to remove fumes, dust or overspray. Secure airhose and fluid hose wrench tight for safety and to prevent leaks.
Maximum Air Pressure 100 P.S.I.
Maximum Fluid Pressure 45 P.S.I.

CLEANING:

Flush clean solvent through the Fluid passages of the Spray Gun and Wipe off the outside with clean solvent. Never leave the entire Spray Gun immersed in solvent. Dirty Aircaps and Tips should be cleaned by soaking in solvent and blown clean with air.

TROUBLE SHOOTING SPRAY PATTERNS:

- (A) **A ROUGH OR STIPPLE FINISH** is due to low or restricted flow of air pressure or too heavy materials being applied with spray gun too close to surface.
- (B) **A WET OR SAGGING FINISH** is due to low air pressure or restricted flow of air, material being too thin, applied too close to the surface.
- (C) **A SPATTERING SPRAY** is caused by air leaking into fluid line or can be caused by a loose fluid tip, a broken or split tip, lumpy material, a clogged vent hole in cover of material cup, air leak at fluid pipe attached to inside of tank cover, or a clogged paint strainer.

TO CORRECT: Tighten tip securely or replace. Strain materials and clean strainer. Spattering might also be caused by worn packing washers, or worn or scored needle.

- (D) **AN ARCHED FAN SPRAY PATTERN** is caused by dried material accumulated in one fan port of the fan aircap distorting the pattern.

TO CORRECT: Dissolve material inside fan port with suitable solvent applied with a small brush.

NOTE: Never use wire or sharp instruments to clean fan ports as permanent damage to the air ports will result in destroying uniformity of the fan pattern.

- (E) **UNBALANCED FAN SPRAY PATTERN**, heavy on one side, may be caused by material collecting around outside of the fluid tip and aircap, or by a loose aircap.

TO CORRECT: Remove aircap and clean fluid tip and aircap with solvent, dry with air pressure. Always be sure fan aircap and aircap body is tightened securely.

- (F) **A HEAVY CENTER** in a fan pattern is caused by insufficient air pressure at the fan port. Rough or shady edges are also caused by low air pressure.

TO CORRECT: Increase air line pressure.

- (G) **A SPLIT FAN SPRAY PATTERN** heavy on each end and light in the center, is caused by excessive air pressure.

TO CORRECT: Reduce air pressure.

SPRAY PATTERNS:



Paasche Airbrush Company

4311 North Normandy Avenue

Chicago, IL 60634-1395

Phone: 773-867-9191 • Fax: 773-867-9198

Website: paascheairbrush.com

E-Mail: info@paascheairbrush.com

Spray Heads for the A-AU- Automatic Spray Guns are available in several different styles, some of which are available with Stainless Steel components. The C.F.M. requirements range from .25 to 3 C.F.M. @ 30 lbs. air pressure. NOTE: When either fluid Tip or fluid Needle is worn and requires replacement, it is recommended that both items be changed for best results. All Tips and Needles are made using 303 Stainless Steel. Carbide Tips and Needles are available for use with abrasive materials.

- **Fan Sizes:** 000/ 0, 1, 2 or 3
- **Application:** General Light Painting, Touch-up and Decorating
- **Fluid Viscosity:** Light
- **Atomization:** External - Fan, Internal - Round

EXTERNAL- FAN PATTERN

1. **ANFA-** Fan Aircap (Brass) (Select Size above)
- 1A. **ANFAS-** Stainless Fan Aircap (Select Size)
2. **AU-12** Aircap Nut
- 2A. **AUS-12** Stainless Aircap Nut (Optional)
3. **AU-** Stainless Tip (Select Size)
4. **A-AU-3-11/16** Stainless Needle

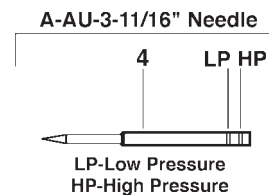
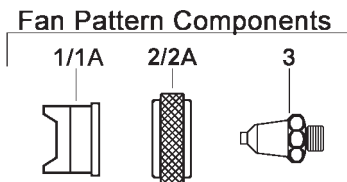

INTERNAL- ROUND PATTERN

6. **AR-15-000/0, 1, 2, or 3** Round Aircap (Brass) (Select Size above)
- 6A. **ASR-15-000/0, 1, or 3** Stainless Round Aircap (Select Size)
7. **AU-12** Aircap Nut
- 7A. **AUS-12** Stainless Aircap Nut (Optional)
8. **AU-** Stainless Tip (Select Size)
9. **A-AU-3-11/16** Stainless Needle

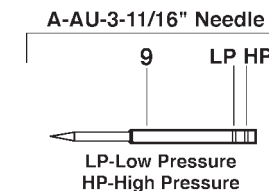
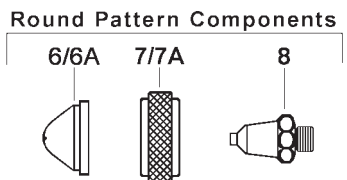

INTERNAL MIX- FAN PATTERN

- **Application:** Broad Coverage
 - **Fluid Viscosity:** Light
 - **Application:** Fluid pressure must be approximately 5 to 10 P.S.I. lower than air atomizing pressure.
10. **ASC-1** Slotted Cap
 11. **AU-6** Cap Nut
 12. **ARA-1** Aircap Body
 13. **AU-12** Aircap Nut
 14. **AU-1** Stainless Tip
 15. **A-AU-3-11/16** Stainless Needle

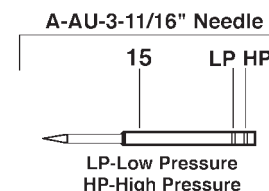
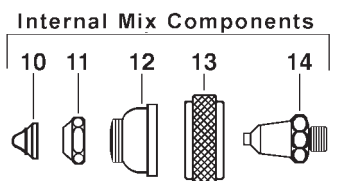

CARBIDE INSERT- FAN PATTERN

- **Size:** 4
 - **Application:** Gritty and Abrasive Material
 - **Fluid Viscosity:** Light Abrasives
16. **ANFAC-4** Fan Aircap (for Carbide Tip)
 17. **AU-12** Air Cap Nut
 18. **AUC-4** Carbide Insert Fluid Tip
 19. **A-AUC-3-11/16** Carbide Insert Needle

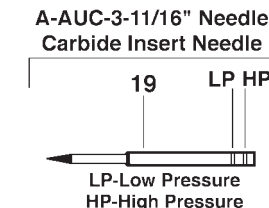
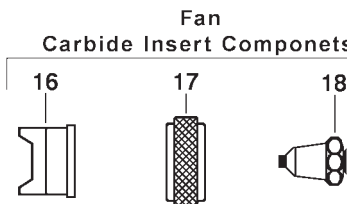

CARBIDE INSERT- ROUND PATTERN

- **Size:** 4
 - **Application:** Gritty and Abrasive Material
 - **Fluid Viscosity:** Light Abrasives
20. **ACR-15-4** Aircap
 21. **AU-12** Aircap Nut
 22. **AUC-4** Carbide Insert Stainless Fluid Tip
 23. **A-AUC-3-11/16** Carbide Insert Stainless Needle

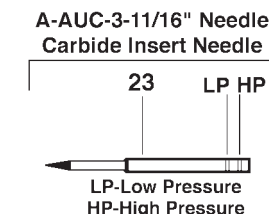
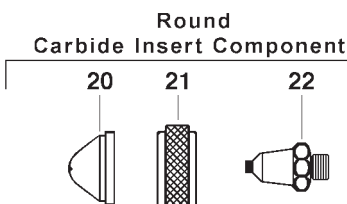

AURE TIP- SPECIAL APPLICATION

- **Application:** May be used in conjunction with Fan or Round pattern Heads. For application of fast settling materials, Needle Seat is in the rear, which prevents material from settling in the Tip cavity.
24. **AURE-** Stainless Tip (Select Size: 0, 1, 2 or 3)
 25. **A-AU-3-3/64** Stainless Needle

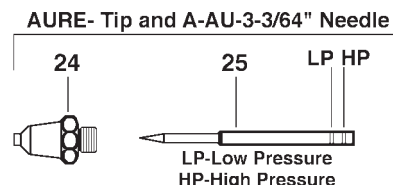

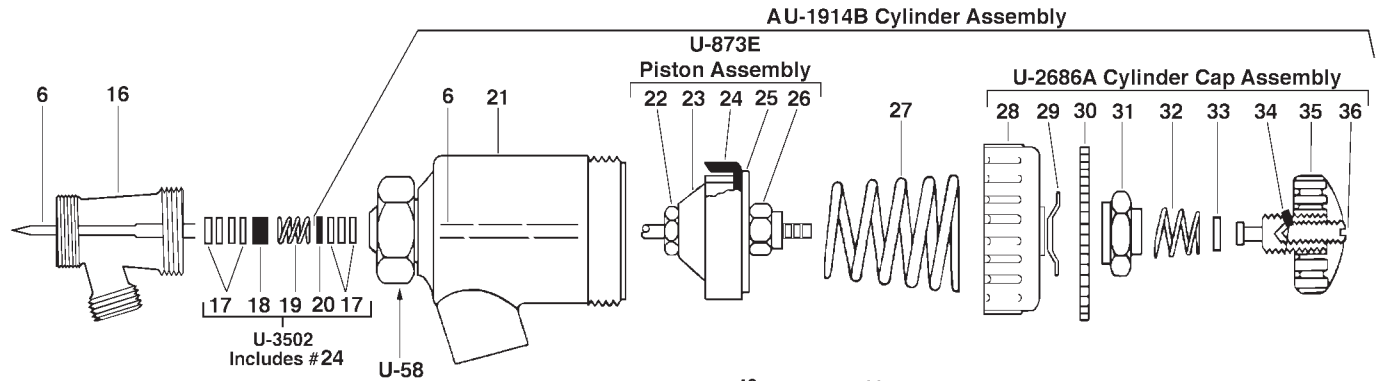

No.	Part No.	Description
6.	A-AU-3-11/16	Needle
16.	AU-7B	Fluid Body

U-3502 Packing Set

17.	U-28-12	Packing Washers (12)
18.	U-29	Packing Gland (1)
19.	DU-30	Stainless St. Spring (1)
20.	U-203	Gland (1) ‡
24.	U-322	Cup Leather (1)

AU-1914B Cylinder Assembly

(Note: Includes U-873E & U-2686A)

6.	A-AU-3-11/16	Needle
17.	U-28-12	Packing Washers (3) ‡
20.	U-203	Gland
21.	U-1907B	Shell Assembly
27.	U-2966	Piston Spring
	U-2687	Light Spring Action (Special Only)

U-873E Piston Assembly

22.	U-2965	Needle Chuck
23.	U-2964	Inner Bushing
24.	U-322	Cup Leather ‡
25.	U-2465A	Outer Disc
26.	U-2544	Locknut

U-2686A Cylinder Cap Assembly

28.	U-2707A	Cylinder Cap
29.	U-941	Spring Washer
30.	U-951B	Fluid Dial
31.	U-2675A	Friction Nut
32.	U-1098	Spring
33.	U-2584P	Stop Washer
34.	59-57	Lock Stud
35.	U-3178	Fluid Adjusting Knob †
36.	59-56	Lock Screw

† Do Not Use as a Shutoff by turning all the way Down, It will split the Tip.
Teflon® Packings are available for any model at an additional charge.

59-30 Teflon® Packing Set

19.	DU-30	St. St. Spring
37.	U-3353	Packing (2)
38.	59-24	Teflon® Packing (4)
39.	59-25B	Expander Gland (2)

59-68 Teflon® Piston Assembly

22.	U-2965	Needle Chuck
26.	U-2544	Locknut
40.	59-63	Aluminum Piston
41.	59-64	Teflon® Piston Ring (2)
42.	59-65	Expansion Spring* (1)

- Add letter "X" after the Prefix A for Teflon® Needle Packings.
- Example: A-AUF-2 to AX-AUF-2
- Add Letters "XX" after prefix A for Teflon® Piston and Needle Packings.
- Example: A-AUF-2 to AXX-AUF-2

AU- Fluid Bodies

43.	AU-7B	Standard
	AUS-7B	Standard Stainless Steel
44.	AUA-7B	Independent Atomizing
	AUSA-7B	Independent Atomizing Stainless Steel
45.	AUG-7B	Circulating Fluid
	AUSG-7B	Circulating Fluid Stainless Steel
46.	AUAG-7B	Circulating Fluid Indept. Atomizing
	AUSAG-7B	Circulating Fluid Indept. Atomizing St. St.
51.	AU-7DA	Indept. Atomizing Needle Valve Body
	AUS-7DA	Indept. Atom. Needle Valve Body St. St.

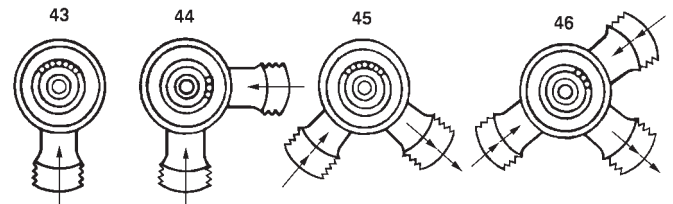

59-68 Piston Assembly

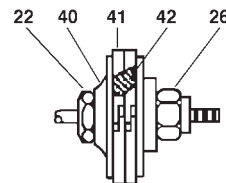

59-30 Packing Set

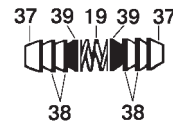

A. Independent Atomizing Needle Valve Assem.

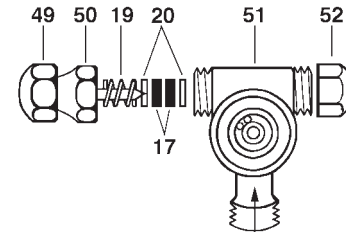

B. Atomizing Air Dial control

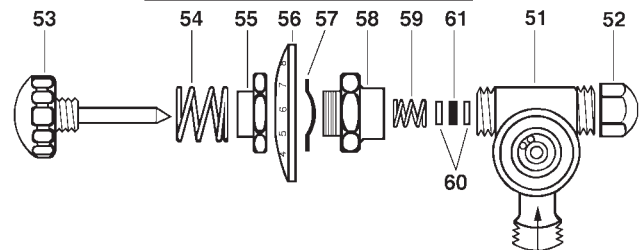

A. Independent Atomizing Needle Valve

(Available in Stainless Steel)

49.	U-166A	Needle Valve
50.	U-167	Spring Cap
19.	DU-30	St. St Spring ‡
20.	U-203	Gland (2) ‡
17.	U-28-12	Pkg. Washers (2) ‡
51.	AU-7DA	Fluid Body
	AUS-7DA	St. St. Fluid Body
52.	U-551	Cap Nut

B. Atomizing Air Dial Control

(Available in Stainless Steel)

53.	U-959	Air Adj. Needle
54.	U-1098	St. St. Spring
55.	U-942	Friction Nut
56.	PA-14	Dial (for AUG-7DA & AUSG-7DA use U-951G Dial)
57.	U-941	Spring Washer
58.	U-957	Bushing
59.	DU-30	St. St. Spring ‡
60.	U-27	Packing Gland (2)
61.	DU-28-12	Packing Washer (1)
51.	AU-7DA	Fluid Body
	AUS-7DA	St. St. Fluid Body
52.	U-551	Cap Nut

‡ Item included in U-3502 Packing Set
U-28-12 and DU-28-12 Packing
Washers sold per Dozen (12) Only.
® DuPont



AREH - TIP

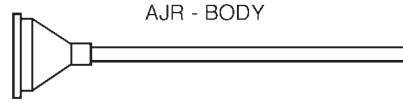

AJR - BODY

Micro Extensions for coating inside small diameters. Will handle most light viscosity fluids. **AREH** Extended Tip & **AJR** Extended Aircap Body.
Use: **A-AU-3-3/64** Needle (Specify Size 3 up to 12)

All AX Aircaps must use a Pressure Feed Cup or Pressure Tank to feed material being sprayed. Always adjust atomizing air pressure higher than fluid air pressure.

A-AU Accessories

- 79. AEN-45 Elbow
- 82. AN Nylon Washer
- 80. AEN-90 Elbow
- 82. AN Nylon Washer

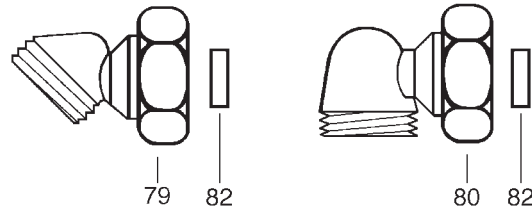

AE- Extensions (For Fan and Round - Heads Only)

- 81. AE-3" Extension L/Needle
- AE-6" Extension L/Needle
- AE-12" Extension L/Needle
- AE-18" Extension L/Needle
- AE-24" Extension L/Needle
- 82. AN Nylon Washer

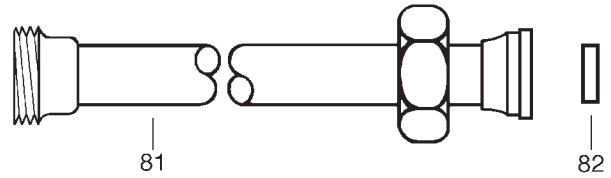

AX- Stainless Steel Extensions (AX - Aircaps & Tips Only)

AX Extensions Complete - Sizes: 3, 6, 12, 18, 24, 36 & 48

- 83. U-2831- Inner Tube (Select Size)
- 84. AUF-29 Nut
- 85. U-2832- Outer Tube (Select Size)
- 86. AX-1 Tip (Not Included with AX Extensions)

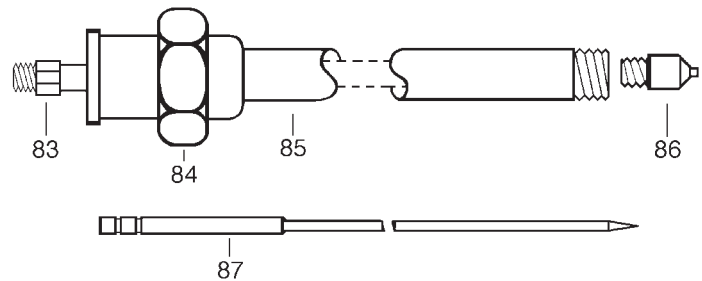

A-AU Extension Needles (Used with AE- & AX- Extensions)

- 87. A-AU-3 Extension Needle
- A-AU-6 Extension Needle
- A-AU-12 Extension Needle
- A-AU-18 Extension Needle
- A-AU-24 Extension Needle
- A-AU-36 Extension Needle
- A-AU-48 Extension Needle

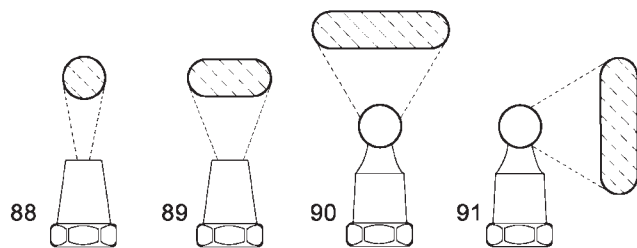

AX Style Aircaps (Used with AX-Extensions Only)

- 88. AXR Aircap (External Round Pattern)
- 89. AXF Aircap (External Fan Pattern)
- 90. AXIF Aircap (Internal Fan Pattern)
- 91. AXIF-90 Aircap (Internal Fan Pattern)
- 92. AXIF-45 Aircap (Internal Fan Pattern)
- 93. AXIB Aircap (Spherical Pattern)
- 94. AXI-360 Aircap (Radial Pattern)
- 95. AXIF-1-90-ASC Aircap (Internal Fan Pattern)
- 96. AXIR-15 Aircap (Internal Round Pattern)
- 97. AXIR-90 Aircap (Internal Round Pattern)

