

Paasche®

H & HS Single Action-External Mix- Siphon Feed Airbrushes

OPERATING INSTRUCTIONS AND REPLACEMENT PARTS

INTRODUCTION:

Paasche® model H Airbrush features machined Brass Body and Nickel Silver Color Part, simplicity of design and ease in operation. The HS is the same Airbrush with the added feature of a threaded swivel nut connector for locking the Bottle Assembly in position, thus offering even greater flexibility in movement. The air and color feeds are independent and adjustable to give a fixed line, shade or stipple effect.

OPERATING INSTRUCTIONS:

Approximate Working Pressures:

- 20 lbs. or Less: Stipple and granulated effects, pressure will vary with viscosity of fluid.
- 20 to 30 lbs.: Medium consistency water colors, inks & dyes.
- 30 lbs. or More: Heavy fluids, acrylics, reduced lacquers, varnishes, paints or ceramic glaze.

Sizes:

- H-1 Color Part and HC-1 Aircap for light fluids.
- H-3 Color Part and HC-3 Aircap for medium fluids.
- H-5 Color Part and HC-5 Aircap for heavier fluids.

1. Attach hose to air supply and allow air to blow a few seconds. Shut off before attaching to Airbrush. This procedure will remove dirt from airline and hose.

Caution: Hold firmly and point away from face.

2. Attach AC-20 (1/8"-1/4"-40) thread Coupling to the Airbrush.
3. Attach Color Cup or Bottle to HN-1, 3, or 5 Needle by exerting a firm twisting motion to fit tapered tube securely into tapered Needle inlet. For HNS-1, 3 or 5 fasten swivel nut to threaded coupling on bottle. To remove Color Cup from HN- Needle, exert a backwards twisting pulling motion.
4. Fill Color Cup or Bottle 1/2 to 3/4 full. Use eyedropper or brush for adding small amounts of color to metal color cup. When using Color Bottle, vent hole must be kept open.
5. To Spray, hold Airbrush like a pencil comfortably between thumb and forefinger using middle finger as a guide and support. Like writing, hold forefinger easily on H-155 Finger Button and Press to open air valve.
6. Regulate volume of color and size of spray by rotating HT-1, 3 or 5 Tip clockwise to increase and counter clockwise to decrease flow of color.

Paasche Airbrush Company

4311 North Normandy Avenue
Chicago, IL 60634-1395

Phone: 773-867-9191 • Fax: 773-867-9198

Website: paascheairbrush.com

E-Mail: info@paascheairbrush.com

INSTRUCTIONS AND PARTS LIST H & HS-10/2007
Supersedes Instructions & Parts List H & HS-1/2007

WARNING: Spray materials may be harmful if inhaled or allowed to come into contact with the skin or eyes. Consult the product label and Material Safety Data Sheet supplied for the spray material. Follow all safety precautions. **CAUTION:** Well Ventilated Area Required to remove fumes, dust or overspray. Secure airhose to Airbrush with V-62 Wrench for safety and to prevent air leaks.
Maximum Air Pressure 75 P.S.I.

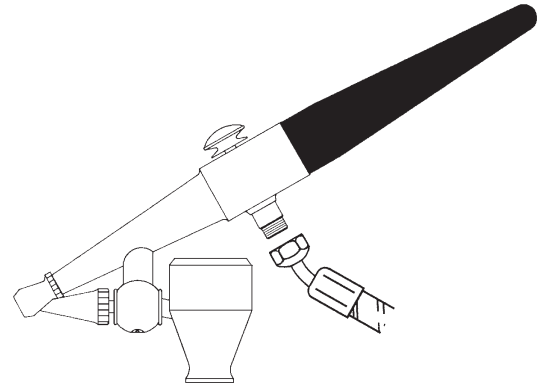

7. Stipple Adjustment: Reducing the airline pressure is the easiest method used when creating a stippled effect with the airbrush. Pressure can be reduced by allowing air to bleed (be released) from any of the following items: D535 Bleeder Valve on the D500 Compressor, 3A Needle Valve installed on the H-128A Valve Casing of the Airbrush or the Escape Valve on the D Compressor.
8. To adjust for heavier fluids, turn tip wide open, loosen set screw, slide needle back to obtain better flow.

CARE AND CLEANING

1. Pour any remaining color back into its original container.
2. Wipe Color Cup or Bottle clean, using cloth moistened with proper solvent.
3. Hold Airbrush at a downward angle and put a few drops of solvent through the H- or HS- Color Adjusting Part Assembly. To flush out the remaining color in the H or HS Color Adjusting Part Assembly, apply pressure to the H-155 Finger Button.
4. Apply a tiny dab of Vaseline to the H- or HS- Color Adjusting Part and HC- Aircap threads every two or three months to prevent color build up and consequent freezing of the Color Adjusting Part Assembly and Aircap.

HOW TO OPEN CLOGGED FLUID PASSAGES

1. Agitate color in Bottle Assembly by placing finger momentarily over HC- Aircap while air is passing through the Airbrush. This will blow color back into bottle thus opening clogged fluid passages. **Do not do this with a cup as color may blow out of cup.**
2. Should H-1, 3 or 5 Color Adjusting Part Assembly become clogged, loosen H-153 Set Screw, unscrew HT-1, 3 or 5 Tip from HN- or HNS- Needle, gently pull back through ball-shaped support and remove Tip.
3. Clean Parts carefully, using nothing harder than a wooden toothpick.
4. To reassemble, reverse this procedure, making sure the shoulder of the Needle seats up against ball-shaped support.
5. If the needle and tip are completely clogged, soak in a closed bottle of proper solvent until clean.

Printed in the U.S.A.

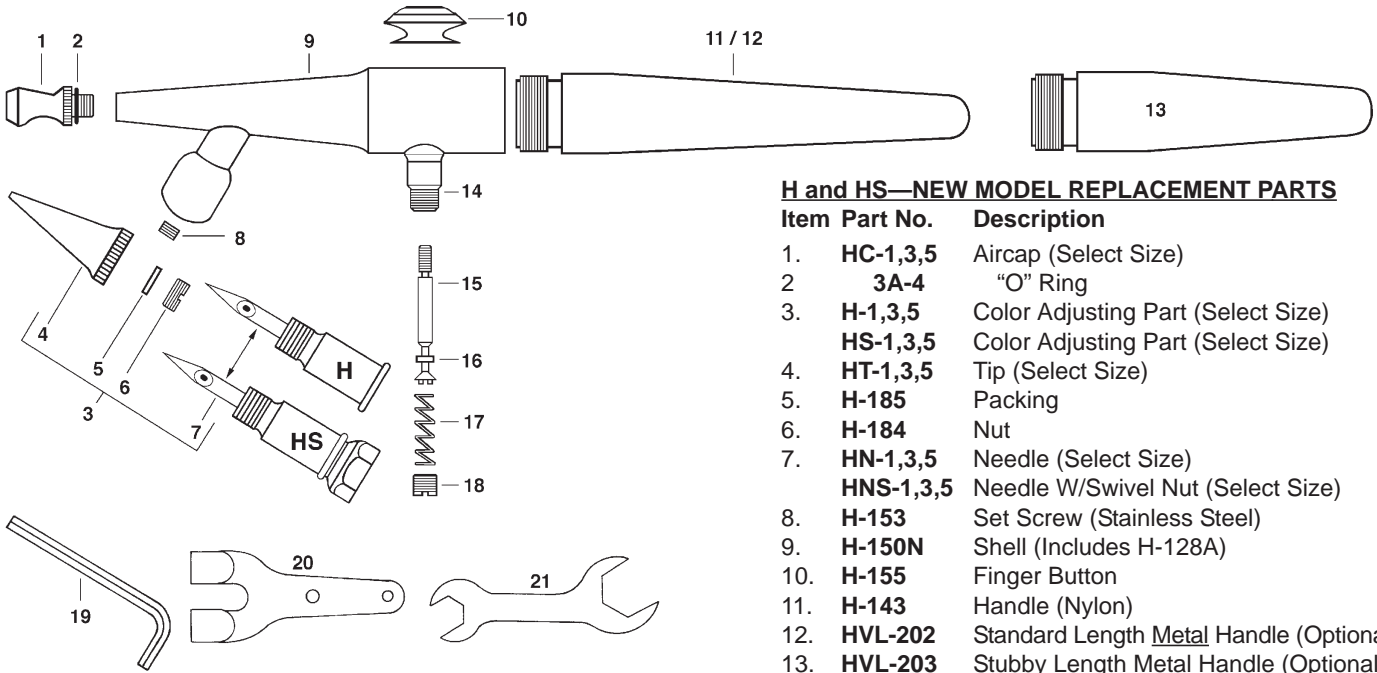

H and HS Airbrush Metal Color Cups, Glass and Plastic Bottle Assemblies

- * Plastic Cover, Metal Tube and Glass Bottle.
- ** Plastic Cover, Tube and Bottle.
- *** Aluminum Cover and Cup.

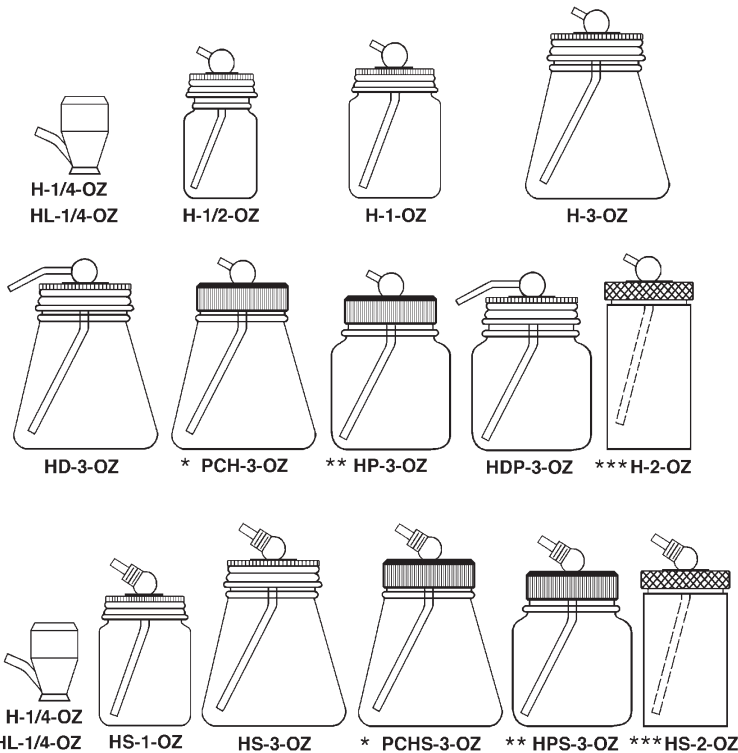

H & HS Airbrush Airhoses with Factory Installed Couplings and replacement Couplings for field installation.

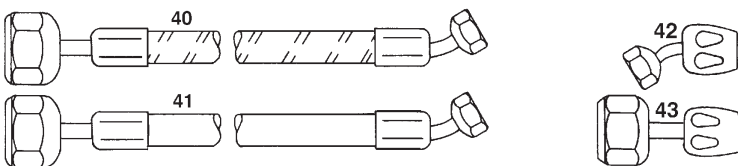

H and HS—NEW MODEL REPLACEMENT PARTS

Item	Part No.	Description
1.	HC-1,3,5	Aircap (Select Size)
2.	3A-4	“O” Ring
3.	H-1,3,5	Color Adjusting Part (Select Size)
	HS-1,3,5	Color Adjusting Part (Select Size)
4.	HT-1,3,5	Tip (Select Size)
5.	H-185	Packing
6.	H-184	Nut
7.	HN-1,3,5	Needle (Select Size)
	HNS-1,3,5	Needle W/Swivel Nut (Select Size)
8.	H-153	Set Screw (Stainless Steel)
9.	H-150N	Shell (Includes H-128A)
10.	H-155	Finger Button
11.	H-143	Handle (Nylon)
12.	HVL-202	Standard Length <u>Metal</u> Handle (Optional)
13.	HVL-203	Stubby Length <u>Metal</u> Handle (Optional)
14.	H-128A	Valve Casing
15.	H-192	Valve Plunger
16.	A-52	Valve Washer (1 Dozen/12)
17.	A-22	Valve Spring
18.	A-23A	Air Valve Nut
19.	F-186	Wrench
20.	A-34	Hanger
21.	V-62	Wrench

H and HS—Old Style Replacement Parts

22.	H-175A	Air Valve Assembly
23.	A-23A	Air Valve Nut
24.	A-22	Valve Spring
25.	H-21A	Valve Plunger
26.	A-52	Valve Washer (Dozen)
27.	H-128A	Valve Casing
28.	A-143	Needle Guide Spring
29.	H-156	Stipple Adjuster
30.	H-157	Finger Lever Assembly

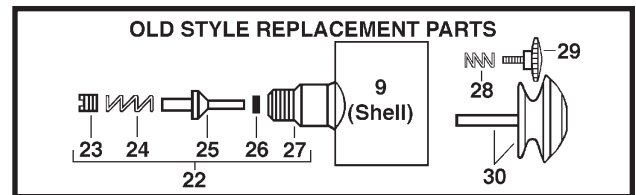

H and HS Cover Assemblies and Gaskets

31.	H1	1oz. H Cover Assembly
33.	HS1	1oz. HS Cover Assembly
	5-G	1oz. Gasket
34.	H1/2	1/2 oz. H Cover Assem. W/Gasket
	3-JG	3 oz. Gasket (Use W/2 oz.)
37.	H3	3 oz. H Cover Assembly
	PCH3	NYLON Cover Assembly
39.	HS3	3 oz. HS Cover Assembly
	PCHS3	NYLON Cover Assembly
	3-JG	3 oz. Gasket

Air Hoses W/Factory Installed Couplings

40.	A-1/8	Braided Air Hose W/Couplings
41.	HP-1/8	PVC-Red Plastic Hose W/Couplings

Couplings—Old Style Replacements

42.	AC-20	1/8"-1/4"-40 Coupling (To Airbrush)
43.	AC-1/8	-1/4" Coupling (To Compressor)